

Kathleen P. Farrell, Ph. D.
Superintendent

Beginning this September 8th, the parent pick up/drop off and bus location on our secondary campus will change. All students grades 6 - 12 will be affected.

Safety and security - for students and staff - have always been the first and most important consideration in all of our district's construction projects. The changes which have been made to our arrival and dismissal pattern reflect this concern, and have been thoroughly discussed and reviewed with our Village Police Chief, Dept of Public Works, our Board of Education, building Principals, our Owner's Representative for Construction, our Architect, and our Health and Safety Committee.

As parents and staff, I know that you join our Board of Education, administrative team and myself, in working to make our environment as safe as possible. This plan separates cars and buses, a goal of all NYS Department of Education as well as Department of Transportation plans for school facilities. Students will not be walking between vehicles, onto roadways, or through moving parking lot traffic to enter or exit from a parent vehicle. With two bus exits to use, our afternoon bus departure should be more rapid - and there should be less congestion at the West Main/West Bridge traffic light. Staff and students who park private vehicles in the high school parking lots will be able to access these lots easily using the West Bridge entrance in the morning - and exit onto West Main in the afternoon.

Beginning September 8th.....

- Parent drop off and pick up will be at only two locations for all students Grades 6 - 12.

Vehicles may enter the Middle School circle to drop off students in the morning, or, pick up students in the afternoon.

Vehicles may also drop off or pick up students in the "idling" area which has been paved directly in front of the Middle School on west side of West Main Street.

Please note that parking of vehicles is prohibited in both of these areas; they are exclusively for "in/out" access. School visitors should park in the paved lot on the east side of West Main, across the street from the Middle School building, or, in the visitors slots in the High School parking lot.

These areas provide a safe entrance and exist for students walking to and from vehicles.

- All bus activity will be sited directly in front of the High School main entrance, with the exception of small buses, which will be located at the High School Gym entrance.

Grade 6 - 12 students who use the bus service will be discharged and board buses at these (main high school door or high school gym door) locations.

Buses will exit the campus via West Main Street or West Bridge Street.

- The current entrance to the High School rear parking lots, from West Bridge opposite Broome, will be repaved and will become a two-way drive rather than the one-way drive it is currently.

Cars will be permitted to enter the campus property from West Bridge using this new drive. Cars will not be permitted to use this roadway as an exit during school hours. Cars must exit from the campus using the West Main Street exit (driving along the Verizon building....).

Buses will use the new roadway or the West Main Street exit to leave the campus in the morning and when exiting in the afternoon.

No left turn onto West Bridge Street will be permitted at any time.

District staff will be present at our bus locations; parent pick-up/drop off location, and to assist as needed at the West Bridge Street location with bus exit. Our Village Police Department will continue to provide patrol support on West Main and as needed on West Bridge.

Many "thank you's in advance" for your anticipated cooperation with our new traffic plan. Yes, it is not what we have always done - it is safer than what we have always done, and thus, a necessary adjustment to our old habits.

Please refer to the attached diagram which shows all areas discussed above. Should you have any questions concerning the plan, please contact your building principal or the transportation office for clarification.

See you in September - with less congestion, safer movement, and smiling faces!

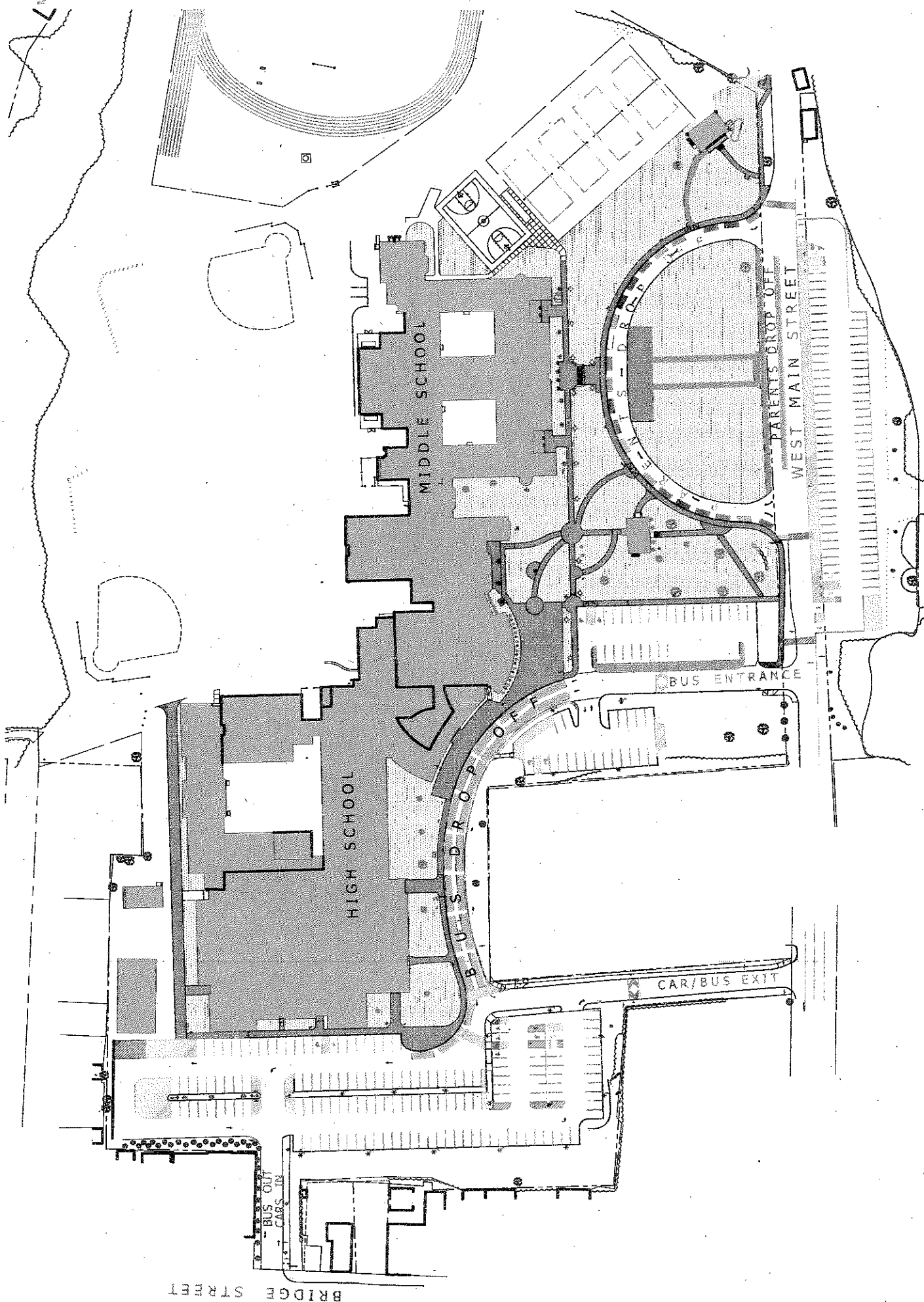

BRIDGE STREET

MIDDLE SCHOOL

HIGH SCHOOL

BUS-DROP-OFF

BUS ENTRANCE

CAR/BUS EXIT

PARENTS DROP OFF

WEST MAIN STREET

